

Kessil

LED PhotoReaction Lighting

PR Controller

USER MANUAL

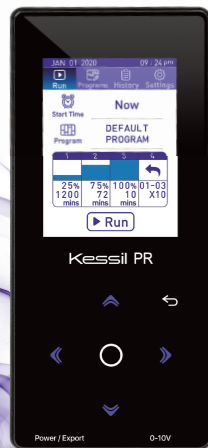

INSIDE THE BOX

- PR Controller
- Magnetic plate (with double-sided tape x 2)

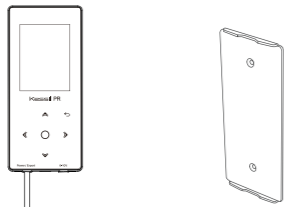

- 5V/1A USB Wall Charger

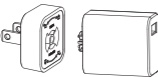

- Warranty Card



- Kessil Brand Sticker



- Quick Start Guide

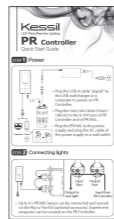

- 1 x 0-10V Unit Link Cable, 6 feet / 180cm

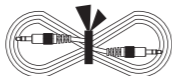

- 1 x 0-10V Unit Link Cable, 3 feet / 90cm

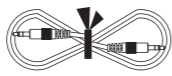

- 2 x 0-10V Unit Link Cable, 20 inches / 50cm

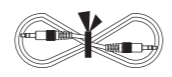

NAVIGATION

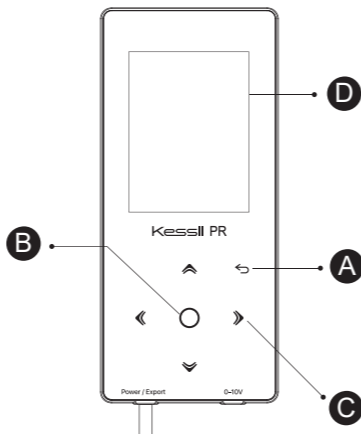

- A Return
- B Enter
- C Direction Pad
- D Display Screen (Not a touch screen)
- E Power / Export USB-A Cable
- F 0-10V Output Port
- G 0-10V Unit Link Cable, 6 feet / 180cm
- H 0-10V Unit Link Cable, 3 feet / 90cm
- I 0-10V Unit Link Cable, 20 inches / 50cm

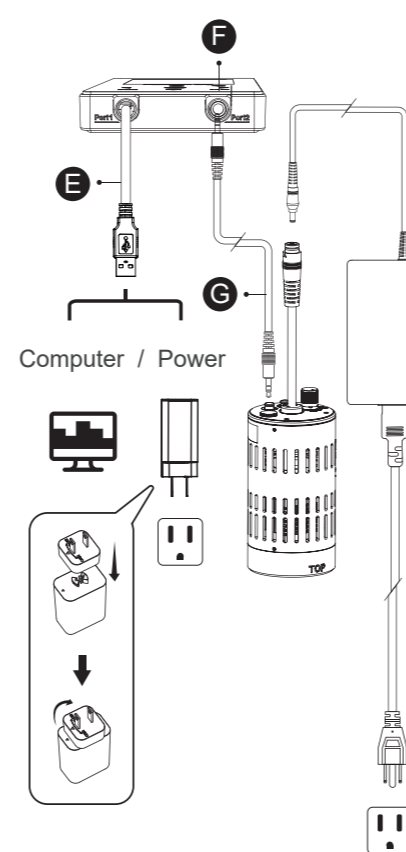

GETTING STARTED

Step 1 Power & Connection

- Plug the USB-A Cable "pigtail" (E) to the USB wall charger or a computer to power on PR Controller.
- Plug the Unit Link Cable (6 feet / 180cm) to the 0-10V port of PR Controller and of PR160L (input port).
- Plug the PR160L to the power supply and plug the AC cable of the power supply to a wall outlet.

Full Setup

Up to 4 x PR160L lamps can be connected and synced on the Rig w/ Fan Kit (optional accessory)

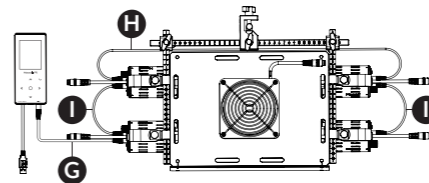

Step 2 Set Up

- Use the Direction Pad (C) to navigate to the **Settings** tab.
- Press to access the settings.
 - Set the current date & time
 - Set the preferred language
- Press to return to tab options.

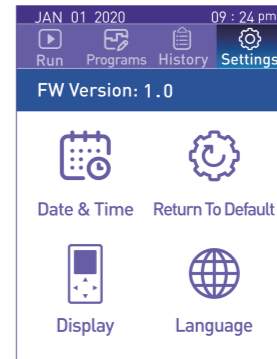

kessil.led

kessiltube

@kessilled

@kessilPR

kessil.com

Kessil PhotoReaction Lighting
A DiCon Brand
 1689 Regatta Blvd,
 Richmond, CA 94804
 (510) 620-5250

Step 3 Run

- Use the Direction Pad (C) to navigate to the **Run** tab.
- Press to access the Run settings
- Press to select start time : Now / 10 minutes / 1 hour later / Press to navigate to the Program row.
- Press to select program. Press to navigate to the Program Graph.
- Press to view steps. Press to navigate to button.
- Press to start program.
- Hold Button : Freeze lights and stay in this step.
- Pause Button : Pause the program and turn off lights.
- Abort Button : End the program.

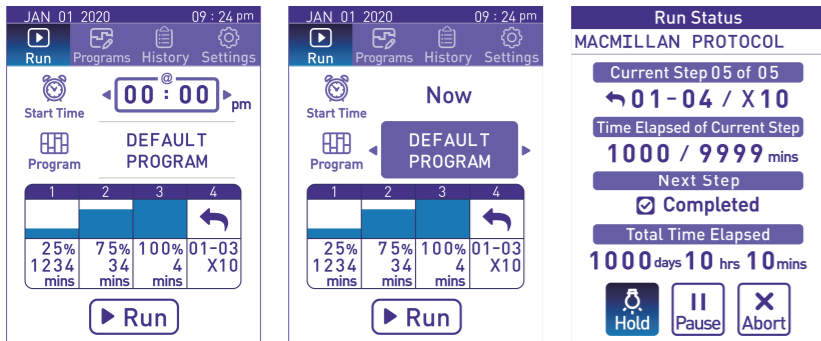

Step 4 Programs

- Use the Direction Pad (C) to navigate to the **Programs** tab.
- Press to access the Programs settings.
- Press and then to select to add a new program or to delete a program.
- Press to select the program, press to edit program's details.
- Edit Program Name : Press to edit program's name.
- Press and then to select or .
- Press and to edit step .
- Press and then to adjust "**Intensity**" or "**Go to Step**".
- Press to save the Program settings.

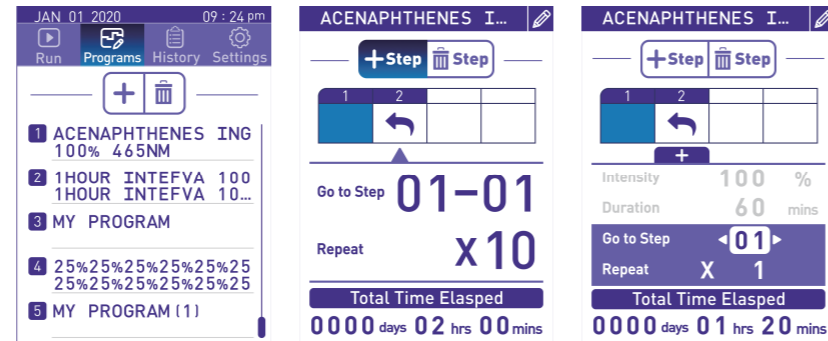

Step 5 History Note & PC Tool

- Use the Direction Pad (C) to navigate to the **History** tab.
- Press to access the History note.
- History notes show the programs that were executed.

PR Controller PC Tool

- Plug the USB-A cable "pigtail" (E) to the computer and open the PR Controller PC Tool (download from Kessil website)
- Update firmware or export History log file.
- Select program under "History List" and the format under "Time Format" to generate program graph.
- Export history notes in CSV or TXT file format.



Step 6 Mounting

- Use the double-sided tape provided to secure the magnetic back plate to a wall or chemical hood window.
- Simply place the PR Controller onto the magnetic back plate.

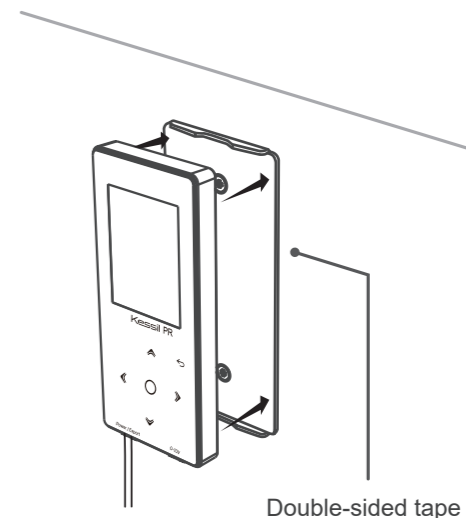

Job well done !

SAFETY INSTRUCTIONS

- DO NOT** use a power adapter outside the specifications. This is a fire hazard and may lead to unit failure.
- DO NOT** use outdoors. This unit is intended for indoor use only.
- DO NOT** expose unit to an extremely humid environment or submerge unit in water.
- DO NOT** mount over open water.
- ENSURE** that the back plate is correctly mounted to a steady surface. Incorrect mounting can result in detachment of the plate and controller.

DC input	
Power consumption	1W maximum
Input Voltage	5VDC +-5%

For further assistance, contact Kessil customer service at (510) 620-5250.